



MAKE WORK
LIFE EASIER



INTELLIGENT
TORCH SOLUTIONS

ARC X SERIES



A Passion for Technology & Innovation

To produce hand tools that reach the pinnacle of performance, durability and functionality you have to be passionate about what you do.

At Arc Torchology the research and development department is the beating heart of our company.

Every single component is conceived, developed, manufactured and tested in-house.

Our development and testing activities are loaded with cutting edge technologies, many of which have been developed specifically by us to meet the very stringent demands we place on our design solutions.

These specialized, bespoke solutions allow us to develop products that surpass the prerequisite of industry standards, inventing increasingly more beneficial products that deliver maximum results for the operator.

This is not business as usual.

FEATURING NEW TECHNOLOGIES



find out more arctorchology.com

Contents

Arc X Range Overview and Ratings	2
----------------------------------	---

Torch Range

Fume Air-Cooled Series

X1	8
X2	10
X3	12

Fume Liquid-Cooled Series

X5W	14
-----	----

Wear Parts

Fume Nozzles	16
Nozzles	16
Fume Adaptors	17
Contact Tips	17
Tip Adaptors	19
Insulators	20
Liners	21



The No - Compromise Solution to Welding Fume

What is Welding Fume?

Welding fume is generated when metals are heated to high temperatures.

Its hazardous composition varies by metal and welding process, containing a range of dangerous substances including:

Metals such as iron, manganese, nickel, chromium, aluminium

Gases such as carbon monoxide, ozone, nitrogen oxides

Particulates such as metal oxides, silica, fluorides

Welding fume is increasingly being recognised as a serious health hazard both to the welder and those working nearby.

It is essential to protect workers from the short and long-term risks.

The Dangers

Classified as carcinogenic to humans, welding fume poses both immediate (irritation, breathlessness, metal fume fever) and severe long-term health risks (cancer, COPD, other lung conditions) to welders from inhalation.

Prevention

Efficient, multi-layered extraction methods are crucial in protecting welder's health.

Local Exhaust Ventilation (LEV) at the source, including the use of fume extraction welding torches, is highly effective at capturing harmful fumes directly at the welding arc.

The Problem

While extraction at the source is one of the most effective methods for mitigating the dangers of welding fume, welders have traditionally faced challenges with fume extraction torches.

Their bulkiness, awkwardness, and discomfort often cause fatigue and reduced control, creating a barrier to use.



Arc Torchology has changed that.

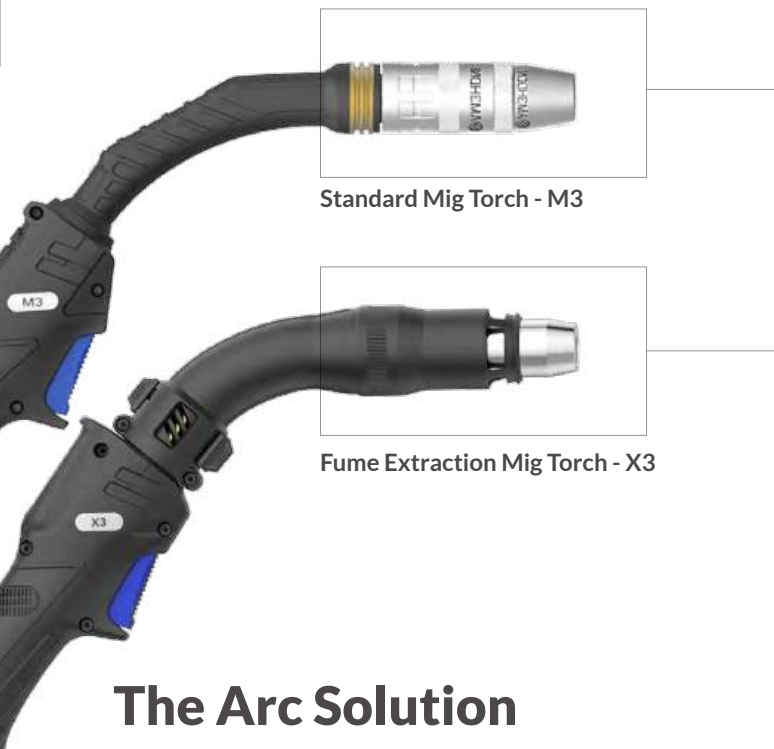

Our Goal?

To replace a standard torch with a fume extraction torch **without compromising on performance or handling for the welder.**

The Arc Solution

There is no need to sacrifice comfort, control or the quality of the weld in order to maintain a safe workplace.

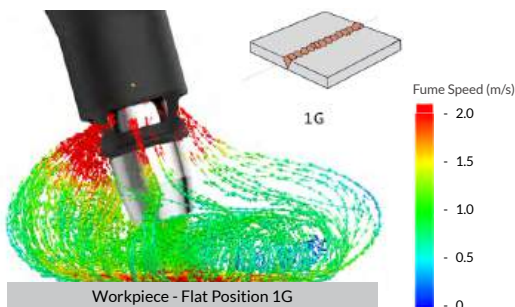

Arc design solutions minimize the impact of fume extraction on the weld pool, effectively reducing turbulence whilst optimizing performance.

With Arc Torchology, there is no trade off between safety and performance – fume extraction torches provide both. Welders can achieve optimal weld quality while safeguarding their health.

Key Features



Unobstructed Visibility

Nozzles enable effective extraction from any angle without obstructing the view or access.



SIC TECHNOLOGY

Twist the nozzle and the spatter falls off

Prioritising both welder safety and weld quality, the Arc X Series delivers quantifiable benefits that extend beyond health protection, including enhanced productivity and reduced operational inefficiencies.



Easy Airflow Adjustment

The slider is conveniently positioned for easy access, no matter how you hold the torch. It is designed to prevent fume and smoke residue from affecting performance and to minimize the buildup of fume particles.



With Fume Extraction

Without Fume Extraction

High Performance Welds

Consistent, uniform suction across an expanded extraction area, coupled with optimized nozzle geometry, minimizes shielding gas turbulence, preserving weld quality.



Reduced Welder Fatigue

Balanced weight distribution means less wrist strain and better control for all-day welder comfort, whatever the position.

Optimized grip comfort for reduced physical strain.

High Durability Consumables

Longevity

- Contact tips last up to **6 times** longer
- Nozzles last up to **3 times** longer
- Tip adaptors last up to **5 times** longer



Light and Manoeuvrable

A lightweight cable and hose system combined with a knuckle joint and support eliminates the feeling of “dragging” the cable.

Extraction channels are designed for minimal weight and bulk.

Plus Simplified Maintenance

- Easy disassembly and cleaning
- Easily remove and clean whilst sucking fume deposits away using the fume extraction unit



Maintenance Guide



TECHNICAL SPECIFICATIONS

Kilowattage (KW) represents the total power required for a welding application.

It can be linked with the published KW ratings of the ARC series torches for a more reliable method of checking the ratings of a torch for a given application.

$$\frac{\text{Welding Amperage} \times \text{Welding Voltage}}{1000} = \text{KW}$$

X1 IEC/EN 60974-7 ISO21904-1

Cooling Method		Air-Cooled	Max Load
Rating:	CO ₂	180A	4.5KW
	Mixed Gas M21	150A	3.0KW
Duty Cycle		60%	
Wire Size		0.6-1.0mm	
Volume Flow Rate	Fume Nozzle	41 m³/h	
	Connector	50.9 m³/h	
Pressure Drop		5.26 kPa	
Shielding Gas Flow Rate		10-13 l/min	
Efficiency		93%	



X2 IEC/EN 60974-7 ISO21904-1

Cooling Method		Air-Cooled	Max Load
Rating:	CO ₂	250A	8.0KW
	Mixed Gas M21	220A	6.0KW
Duty Cycle		60%	
Wire Size		0.8-1.2mm	
Volume Flow Rate	Fume Nozzle	48 m³/h	
	Connector	56.0 m³/h	
Pressure Drop		6.03 kPa	
Shielding Gas Flow Rate		10-15 l/min	
Efficiency		93%	



LIQUID-COOLED

Arc Fume Series



MAKE WORK
LIFE EASIER

X3 IEC/EN 60974-7 ISO21904-1

Cooling Method		Air-Cooled	Max Load
Rating:	CO ₂	300A	11.3KW
	Mixed Gas M21	270A	8.9KW
Duty Cycle		60%	
Wire Size		0.9-1.2mm	
Volume Flow Rate	Fume Nozzle	52 m ³ /h	
	Connector	65 m ³ /h	
Pressure Drop		6.2 kPa	
Shielding Gas Flow Rate		16-18 l/min	
Efficiency		93%	



X5W IEC/EN 60974-7 ISO21904-1

Cooling Method		Liquid-Cooled			
		Cooler Rating	Max. A	Pulse	Max. Load
Rating: CO ₂		1000W	500A	-	20.0KW
Rating: Mixed Gas M21		1000W	450A	300A	17.1KW
Duty Cycle			100%	100%	
Wire Size		Filler Wires	Fe, Fe-MC / FC		0.9-1.6mm
		Filler Wires	Ss, Ss-MC / FC		0.9-1.6mm
		Filler Wires			1.0-1.6mm
Volume Flow Rate	Fume Nozzle	52 m³/h			
	Connector	66 m³/h			
Pressure Drop		10 kPa			
Shielding Gas Flow Rate		16-22 l/min			
Efficiency		93%			
Minimum Liquid Flow Rate			1.5 l/min	Important: Please note minimum inlet pressure and flow rate. Low pressure will affect torch performance	
Minimum Liquid Inlet Pressure			2.5 Bar		
Maximum Liquid Inlet Pressure			5.0 Bar		
Maximum Liquid Inlet Temperature			50°C		
Operating Temperature Range			-10...+40°C		



X1 Air-Cooled X Industrial Mig Fume Torch

Ratings:	180A CO ₂ , 150A mixed gas M21, EN60974-7 @ 60% duty cycle. 0.6mm-1.0mm wire
Technical specification:	Shielding Gas Flow Rate: 10-13 l/min Extraction Volume Rate at Nozzle: 41 m ³ /h

The Arc X1 is designed for semi-industrial settings with a 180A duty cycle. It effectively captures fumes at the source, minimizing dispersion and ensuring cleaner air.

ARC X INDUSTRIAL MIG FUME TORCH PACKAGES

Arc X1 Torches are supplied with a front leather cover and Euro termination as standard and are supplied 'ready to weld' with all wear parts fitted.

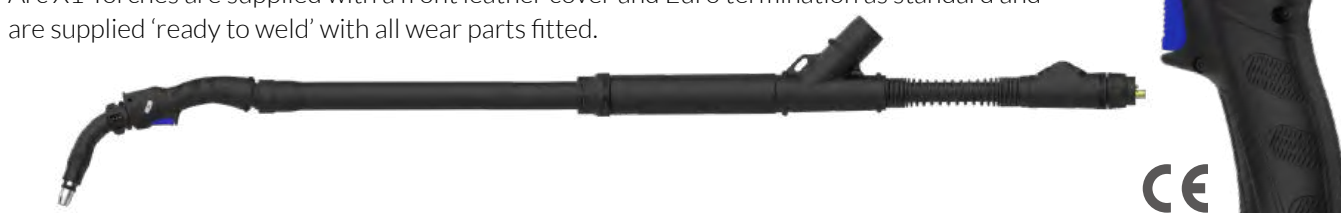

	3mt	4mt	5mt
Fume X Torch c/w Front Leather	X1-3M	X1-4M	X1-5M
Fume X Torch c/w Front Leather, Air Flow and Gas Flow Meter	X1-3M-FM	X1-4M-FM	X1-5M-FM
Fume X Torch Full Leather	X1-3M-LE	X1-4M-LE	X1-5M-LE
Fume X Torch Full Leather c/w Air Flow and Gas Flow Meter	X1-3M-LE-FM	X1-4M-LE-FM	X1-5M-LE-FM

Wear Parts

A Fume Nozzles

Part Number	Description	Bore	Wall	Material
AX1FN	Fume Nozzle	18.4mm	1mm	Aluminium

B Nozzles

Part Number	Description	Bore	Wall	Material
AM1TN	Tapered Nozzle Assembly	10.6mm	1.0mm	Copper
•AM1CN	Conical Nozzle Assembly	12mm	1.0mm	Copper

C Fume Adaptors

Part Number	Description	Material
AX1002	Fume Nozzle Adaptor	Aluminium

D Contact Tips

Part Number	Description	Size (mm)	Wire Size (mm-inch)	Material
AM1CT06	Contact Tip	M6*25.0	0.6 - 0.023	Copper
•AM1CT08	Contact Tip	M6*25.0	0.8 - 0.030	Copper
AM1CT09	Contact Tip	M6*25.0	0.9 - 0.035	Copper
AM1CT10	Contact Tip	M6*25.0	1.0 - 0.040	Copper
AM1CT12	Contact Tip	M6*25.0	1.2 - 0.045	Copper
AM1CT08A	Contact Tip	M6*25.0	0.8 - 0.030	Copper
AM1CT10A	Contact Tip	M6*25.0	1.0 - 0.040	Copper
AM1CT12A	Contact Tip	M6*25.0	1.2 - 0.045	Copper

E Tip Adaptors

Part Number	Description	Material
•AM1TA	Tip Adaptor	Brass

F Neck Insulator

Part Number	Description
•AX1003	Neck Insulator

G Liners

Part Number	Description	Wire Size
•AM1535-30	Steel Liner x 3mt	0.6-0.9mm
•AM1535-40	Steel Liner x 4mt	0.6-0.9mm
•AM1535-50	Steel Liner x 5mt	0.6-0.9mm

• Denotes torch package standard wear part set-up



FUME SERIES

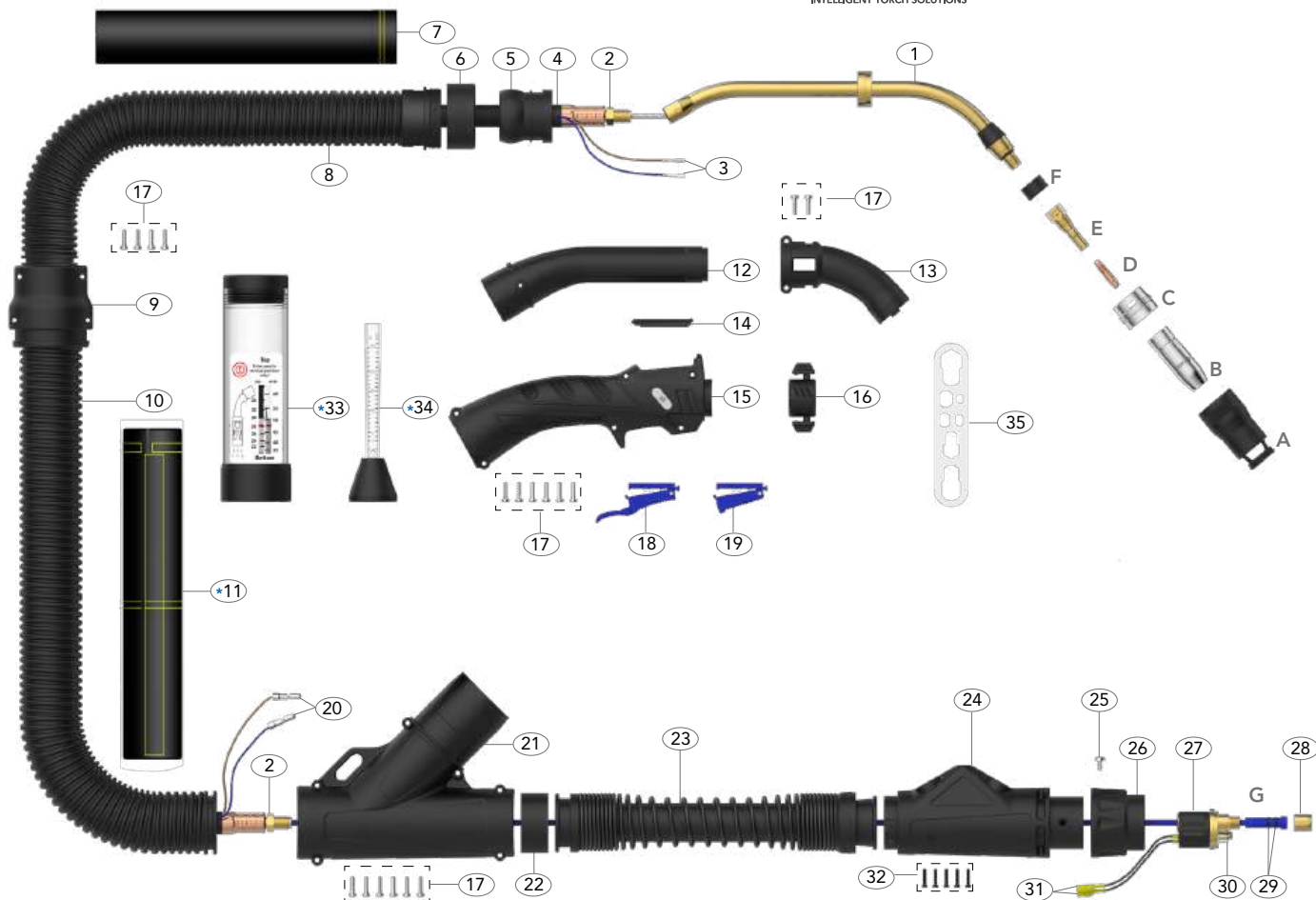

Spare Parts

Part Number	Description
1 AX1001	Swan Neck Assembly
2 AM1505	Lock Nut
3 AM1521	Cable Terminal
4 AX1517-30	Power Cable Assembly x 3mt
AX1517-40	Power Cable Assembly x 4mt
AX1517-50	Power Cable Assembly x 5mt
5 AX8015-1	Ball Joint
6 AX8015-2	Ball Joint Nut
7 AXLC-30 x 1.5M	Front Leather Cover 1.5mt
8 AX4019-1	Front Extract Hose Assembly
9 AX-HRC30-40	Hose Connector
10 AX5019-2-30	Rear Extract Hose Assembly x 3mt
AX5019-2-40	Rear Extract Hose Assembly x 4mt
AX5019-2-50	Rear Extract Hose Assembly x 5mt
12 AX3-IFC	Inner Fume Chamber
13 AX1-OFC	Outer Fume Chamber
14 AM2514-C	Handle Control Cover
15 AX2514	Fume Handle Assy
16 AX3-AFR	Air Flow Regulator
17 AXSP1-1	Screw Pack
18 AM2516L	Microswitch Extended Trigger
19 AM2516	Microswitch Standard Trigger
20 AM1522	Cable Terminal Male

Part Number	Description
21 AX-YC	Y' Connector
22 AX1-SR	Sponge Seal Ring
23 AX5019-CS	Connect Spring Assembly
24 AM5022	Housing Assembly
25 AML1541	Gun Plug Screw
26 AM1519	Gun Plug Nut
27 AM1528	Hybrid Gun Plug Body c/w Spring Pins
28 AM1826	Liner Retaining Nut
29 AMLOR	Liner 'O' Ring
30 AM1524	Gun Plug 'O' Ring
31 AM1523	Gun Plug Terminal Female
32 AMSP1-1	Screw Pack
35 AMWS	Wear Parts Spanner

Optional

*11 AXLC-40 x 0.75M	Rear Leather Cover 0.75mt
AXLC-40 x 1.75M	Rear Leather Cover 1.75mt
AXLC-40 x 2.75M	Rear Leather Cover 2.75mt
*33 AX1-AFM	Air Flow Meter
*34 AX-GFM	Gas Flow Meter

X2 Air-Cooled X Industrial Mig Fume Torch

Ratings:	250A CO ₂ , 220A mixed gas M21, EN60974-7 @ 60% duty cycle. 0.8mm-1.2mm wire
Technical specification:	Shielding Gas Flow Rate: 10-15 l/min Extraction Volume Rate at Nozzle: 48 m ³ /h

The Arc X2 is perfect for 0.8-1.2mm hard wires and industrial settings, capturing fume at source to improve air quality and safety.

ARC X INDUSTRIAL MIG FUME TORCH PACKAGES

Arc X2 Torches are supplied with a front leather cover and Euro termination as standard and are supplied 'ready to weld' with all wear parts fitted.

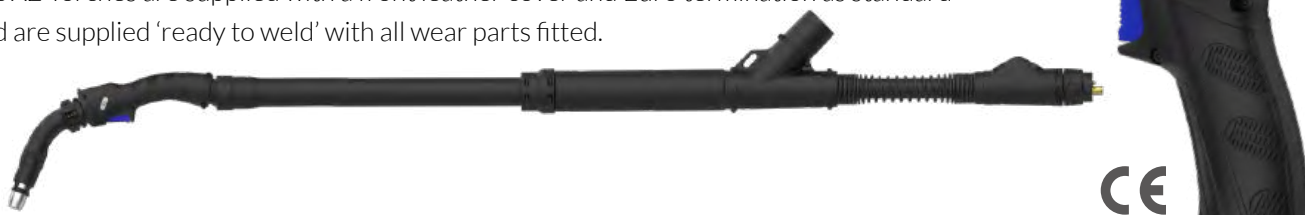

	3mt	4mt	5mt
Fume X Torch c/w Front Leather	X2-3M	X2-4M	X2-5M
Fume X Torch c/w Front Leather, Air Flow and Gas Flow Meter	X2-3M-FM	X2-4M-FM	X2-5M-FM
Fume X Torch Full Leather	X2-3M-LE	X2-4M-LE	X2-5M-LE
Fume X Torch Full Leather c/w Air Flow and Gas Flow Meter	X2-3M-LE-FM	X2-4M-LE-FM	X2-5M-LE-FM

Wear Parts

A Fume Nozzles

Part Number	Description	Bore	Wall	Material
AX2FN	Fume Nozzle	21.9mm	1mm	Aluminium

B Nozzles

Part Number	Description	Bore	Wall	Material
AM2TN	Tapered Nozzle Assembly	12mm	1.9mm	Copper
•AM2CN	Conical Nozzle Assembly	15mm	1.9mm	Copper

C Fume Adaptors

Part Number	Description	Material
AX2002	Fume Nozzle Adaptor	Aluminium

D Contact Tips

Part Number	Description	Size (mm)	Wire Size (mm-inch)	Material
AM2CT08	Contact Tip	M6*25.0	0.6 - 0.023	Copper
AM2CT09	Contact Tip	M6*25.0	0.8 - 0.030	Copper
•AM2CT10	Contact Tip	M6*25.0	0.9 - 0.035	Copper
AM2CT12	Contact Tip	M6*25.0	1.0 - 0.040	Copper
AM2CT08A	Contact Tip	M6*25.0	1.2 - 0.045	Copper
AM2CT10A	Contact Tip	M6*25.0	0.8 - 0.030	Copper
AM2CT12A	Contact Tip	M6*25.0	1.0 - 0.040	Copper

E Tip Adaptors

Part Number	Description	Material
•AM2TA	Tip Adaptor	Brass

F Neck Insulator

Part Number	Description
•AX2003	Neck Insulator

G Liners

Part Number	Description	Wire Size
•AM2524-30	Steel Liner x 3mt	1.0-1.2mm
•AM2524-40	Steel Liner x 4mt	1.0-1.2mm
•AM2524-50	Steel Liner x 5mt	1.0-1.2mm

• Denotes torch package standard wear part set-up



FUME SERIES

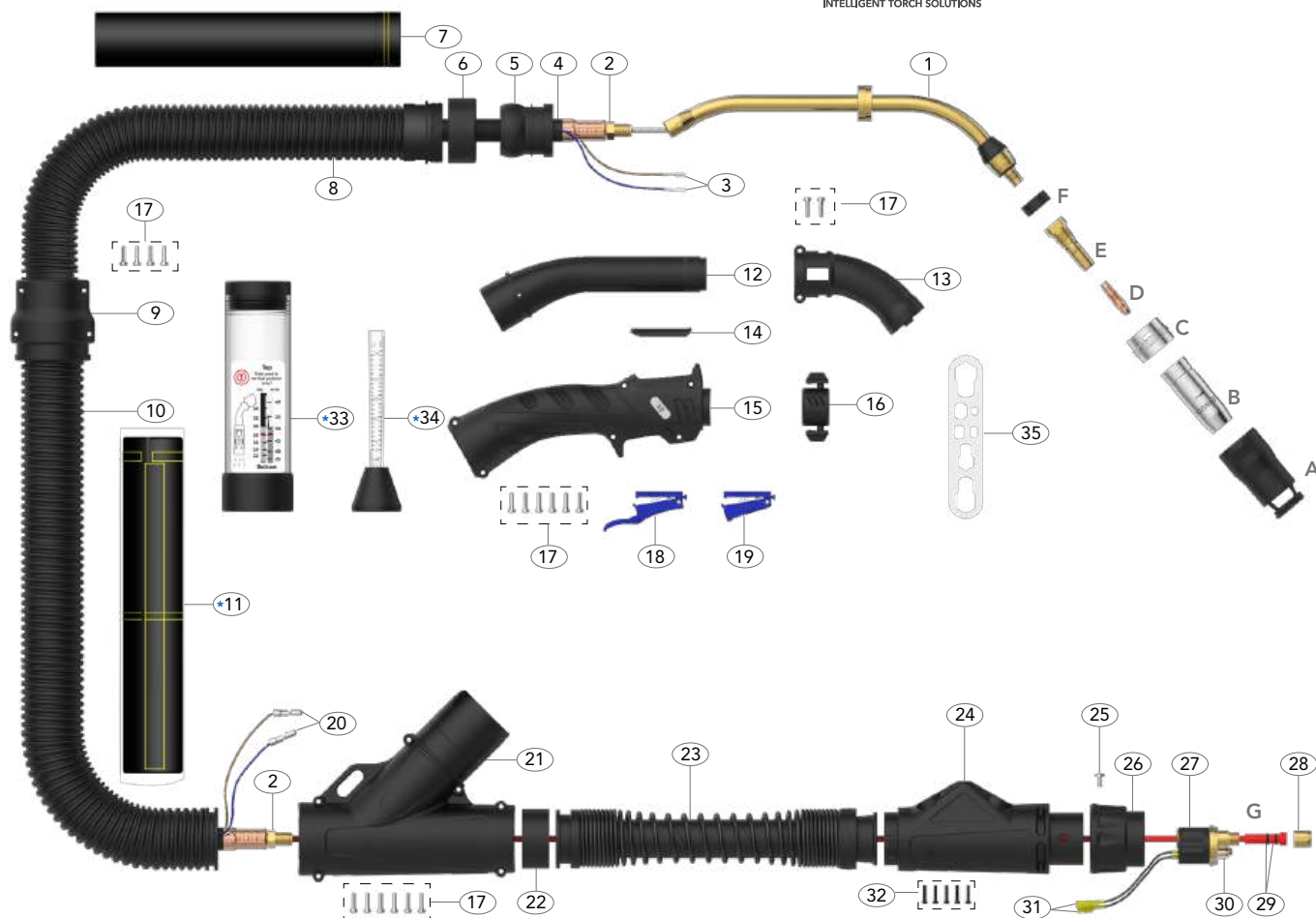

Spare Parts

Part Number	Description
1 AX2001	Swan Neck Assembly
2 AM1505	Lock Nut
3 AM1521	Cable Terminal
4 AX2503-30	Power Cable Assembly x 3mt
AX2503-40	Power Cable Assembly x 4mt
AX2503-50	Power Cable Assembly x 5mt
5 AX8015-1	Ball Joint
6 AX8015-2	Ball Joint Nut
7 AXLC-30 x 1.5M	Front Leather Cover 1.5mt
8 AX4019-1	Front Extract Hose Assembly
9 AX-HRC30-40	Hose Connector
10 AX5019-2-30	Rear Extract Hose Assembly x 3mt
AX5019-2-40	Rear Extract Hose Assembly x 4mt
AX5019-2-50	Rear Extract Hose Assembly x 5mt
12 AX3-IFC	Inner Fume Chamber
13 AX2-OFC	Outer Fume Chamber
14 AM2514-C	Handle Control Cover
15 AX2514	Fume Handle Assy
16 AX3-AFR	Air Flow Regulator
17 AXSP1-1	Screw Pack
18 AM2516L	Microswitch Extended Trigger
19 AM2516	Microswitch Standard Trigger
20 AM1522	Cable Terminal Male

Part Number	Description
21 AX-YC	Y' Connector
22 AX2-SR	Sponge Seal Ring
23 AX5019-CS	Connect Spring Assembly
24 AM5022	Housing Assembly
25 AML1541	Gun Plug Screw
26 AM1519	Gun Plug Nut
27 AM1528	Hybrid Gun Plug Body c/w Spring Pins
28 AM1826	Liner Retaining Nut
29 AMLOR	Liner 'O' Ring
30 AM1524	Gun Plug 'O' Ring
31 AM1523	Gun Plug Terminal Female
32 AMSP1-1	Screw Pack
35 AMWS	Wear Parts Spanner

Optional

*11 AXLC-40 x 0.75M	Rear Leather Cover 0.75mt
AXLC-40 x 1.75M	Rear Leather Cover 1.75mt
AXLC-40 x 2.75M	Rear Leather Cover 2.75mt
*33 AX2-AFM	Air Flow Meter
*34 AX-GFM	Gas Flow Meter

X3 Air-Cooled X High Performance Mig Fume Torch

Ratings:	300A CO ₂ , 270A mixed gas M21, EN60974-7 @ 60% duty cycle. 0.9mm-1.2mm wire
Technical specification:	Shielding Gas Flow Rate: 16-18 l/min Extraction Volume Rate at Nozzle: 52 m³/h

The Arc X3 is the workhorse of the series, delivering a true 300 Amp torch with 98% fume capture at the source.

ARC X HIGH PERFORMANCE MIG FUME TORCH PACKAGES

Arc X3 Torches are supplied with a front leather cover and Euro termination as standard and are supplied 'ready to weld' with all wear parts fitted.



	3mt	4mt	5mt
Fume X Torch c/w Front Leather	X3-3M	X3-4M	X3-5M
Fume X Torch c/w Front Leather, Air Flow and Gas Flow Meter	X3-3M-FM	X3-4M-FM	X3-5M-FM
Fume X Torch Full Leather	X3-3M-LE	X3-4M-LE	X3-5M-LE
Fume X Torch Full Leather c/w Air Flow and Gas Flow Meter	X3-3M-LE-FM	X3-4M-LE-FM	X3-5M-LE-FM

Wear Parts

A Fume Nozzles

Part Number	Description	Bore	Wall	Material
AX3FN	Fume Nozzle	23.4mm	1mm	Aluminium

B Nozzles

Part Number	Description	Bore	Wall	Material
AX3TN	Tapered Nozzle	12mm	2.5mm	Copper
•AX3CN	Conical Nozzle	15mm	2.5mm	Copper
AX3CYN	Cylindrical Nozzle	18mm	2.5mm	Copper

C Fume Adaptors

Part Number	Description	Material
AX3002	Fume Nozzle Adaptor	Aluminium

D Contact Tips

Part Number	Description	Size (mm)	Wire Size (mm-inch)	Material
Standard Series				
AM5CT09	Contact Tip	M8*29.5	0.9-0.035	CuCrZr
AM5CT10	Contact Tip	M8*29.5	1.0-0.040	CuCrZr
•AM5CT12	Contact Tip	M8*29.5	1.2-0.045	CuCrZr
A Series				
AM5CT10A	Contact Tip	M8*29.5	1.0-0.040	CuCrZr
AM5CT12A	Contact Tip	M8*29.5	1.2-0.045	CuCrZr
AM2CT10A	Contact Tip	M8*29.5	1.0-0.040	Copper
AM2CT12A	Contact Tip	M8*29.5	1.2-0.045	Copper

E Tip Adaptors

Part Number	Description	Material
•AM3TAB	Tip Adaptor	Brass
AM3TAC	Tip Adaptor High Performance	CuCrZr

F Liners

Part Number	Description	Wire Size
•AM2524-30	Steel Liner x 3mt	1.0-1.2mm
•AM2524-40	Steel Liner x 4mt	1.0-1.2mm
•AM2524-50	Steel Liner x 5mt	1.0-1.2mm

• Denotes torch package standard wear part set-up



M10 Contact Tip and Tip Adaptors available please refer to Page 18-19

FUME SERIES

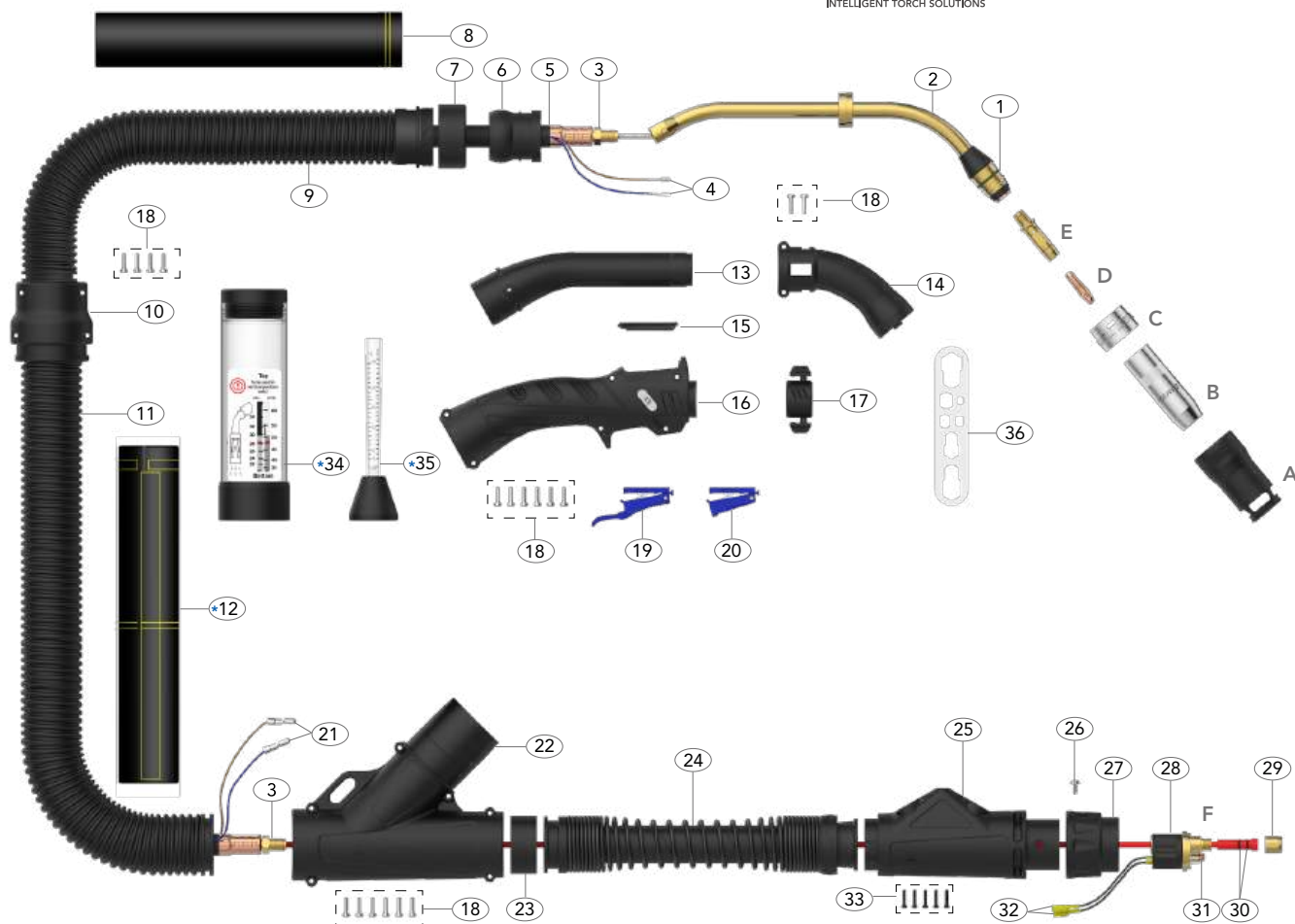

Spare Parts

Part Number	Description
1 AX3-NOR	Neck 'O' Ring
2 AX3001	Swan Neck Assembly
3 AM1505	Lock Nut
4 AM1521	Cable Terminal
5 AX3003-30	Power Cable Assembly x 3mt
AX3003-40	Power Cable Assembly x 4mt
AX3003-50	Power Cable Assembly x 5mt
6 AX8015-1	Ball Joint
7 AX8015-2	Ball Joint Nut
8 AXLC-32 x 1.5M	Front Leather Cover 1.5mt
9 AX5019-1	Front Extract Hose Assembly
10 AX-HRC32-40	Hose Connector
11 AX5019-2-30	Rear Extract Hose Assembly x 3mt
AX5019-2-40	Rear Extract Hose Assembly x 4mt
AX5019-2-50	Rear Extract Hose Assembly x 5mt
13 AX3-IFC	Inner Fume Chamber
14 AX3-OfC	Outer Fume Chamber
15 AM2514-C	Handle Control Cover
16 AX2514	Fume Handle Assy
17 AX3-AFR	Air Flow Regulator
18 AXSP1-1	Screw Pack
19 AM2516L	Microswitch Extended Trigger
20 AM2516	Microswitch Standard Trigger
21 AM1522	Cable Terminal Male

Part Number	Description
22 AX-YC	Y' Connector
23 AX3-SR	Sponge Seal Ring
24 AX5019-CS	Connect Spring Assembly
25 AM5022	Housing Assembly
26 AML1541	Gun Plug Screw
27 AM1519	Gun Plug Nut
28 AM1528	Hybrid Gun Plug Body c/w Spring Pins
29 AM1826	Liner Retaining Nut
30 AMLOR	Liner 'O' Ring
31 AM1524	Gun Plug 'O' Ring
32 AM1523	Gun Plug Terminal Female
33 AMSP1-1	Screw Pack
36 AMWS	Wear Parts Spanner

Optional

*12 AXLC-40 x 0.75M	Rear Leather Cover 0.75mt
AXLC-40 x 1.75M	Rear Leather Cover 1.75mt
AXLC-40 x 2.75M	Rear Leather Cover 2.75mt
*34 AX3-AFM	Air Flow Meter
*35 AX-GFM	Gas Flow Meter

X5W Liquid-Cooled X High Performance Mig Fume Torch

Ratings:	500A CO ₂ , 450A mixed gas M21,EN60974-7 @ 100% duty cycle. 0.9mm-1.6mm wire
Technical specification:	Shielding Gas Flow Rate: 16-22 l/min Extraction Volume Rate at Nozzle: 52 m ³ /h

Designed for heavy-duty, high-demand applications, it ensures high-efficiency fume capture at the generation point, minimizing airborne contaminants.

ARC X HIGH PERFORMANCE MIG FUME TORCH PACKAGES

Arc X5W Torches are supplied with a front leather cover and Euro termination as standard and are supplied 'ready to weld' with all wear parts fitted.



	3mt	4mt	5mt
Fume X Torch c/w Front Leather	X5W-3M	X5W-4M	X5W-5M
Fume X Torch c/w Front Leather, Air Flow and Gas Flow Meter	X5W-3M-FM	X5W-4M-FM	X5W-5M-FM
Fume X Torch Full Leather	X5W-3M-LE	X5W-4M-LE	X5W-5M-LE
Fume X Torch Full Leather c/w Air Flow and Gas Flow Meter	X5W-3M-LE-FM	X5W-4M-LE-FM	X5W-5M-LE-FM

Wear Parts

A Fume Nozzles

Part Number	Description	Bore	Wall	Material
AX3FN	Fume Nozzle	23.4mm	1mm	Aluminium

B Nozzles

Part Number	Description	Bore	Wall	Material
AX3TN	Tapered Nozzle	12mm	2.5mm	Copper
•AX3CN	Conical Nozzle	15mm	2.5mm	Copper
AX3CYN	Cylindrical Nozzle	18mm	2.5mm	Copper

C Fume Adaptors

Part Number	Description	Material
AX3002	Fume Nozzle Adaptor	Aluminium

D Contact Tips

Part Number	Description	Size (mm)	Wire Size (mm-inch)	Material
Standard Series				
AM5CT09	Contact Tip	M8*29.5	0.9 - 0.035	CuCrZr
AM5CT10	Contact Tip	M8*29.5	1.0 - 0.040	CuCrZr
•AM5CT12	Contact Tip	M8*29.5	1.2 - 0.045	CuCrZr
AM5CT14	Contact Tip	M8*29.5	1.4 - 0.055	CuCrZr
AM5CT16	Contact Tip	M8*29.5	1.6 - 0.063	CuCrZr
A Series				
AM5CT10A	Contact Tip	M8*29.5	1.0 - 0.040	CuCrZr
AM5CT12A	Contact Tip	M8*29.5	1.2 - 0.045	CuCrZr
AM5CT16A	Contact Tip	M8*29.5	1.6 - 0.063	CuCrZr
AM2CT10A	Contact Tip	M8*29.5	1.0 - 0.040	Copper
AM2CT12A	Contact Tip	M8*29.5	1.2 - 0.045	Copper

E Tip Adaptors

Part Number	Description	Material
•AX5WTAC	Tip Adaptor High Performance	CuCrZr

F Tip Adaptor Insulators

Part Number	Description
•AX5WTAI	Tip Adaptor Insulator

G Liners

Part Number	Description	Wire Size
•AM2524-30	Steel Liner x 3mt	1.0-1.2mm
•AM2524-40	Steel Liner x 4mt	1.0-1.2mm
•AM2524-50	Steel Liner x 5mt	1.0-1.2mm
AM3631-30	Steel Liner x 3mt	1.6mm
AM3631-40	Steel Liner x 4mt	1.6mm
AM3631-50	Steel Liner x 5mt	1.6mm

•Denotes torch package standard wear part set-up



M10 Contact Tip and Tip Adaptors available please refer to Page 18-19

FUME SERIES

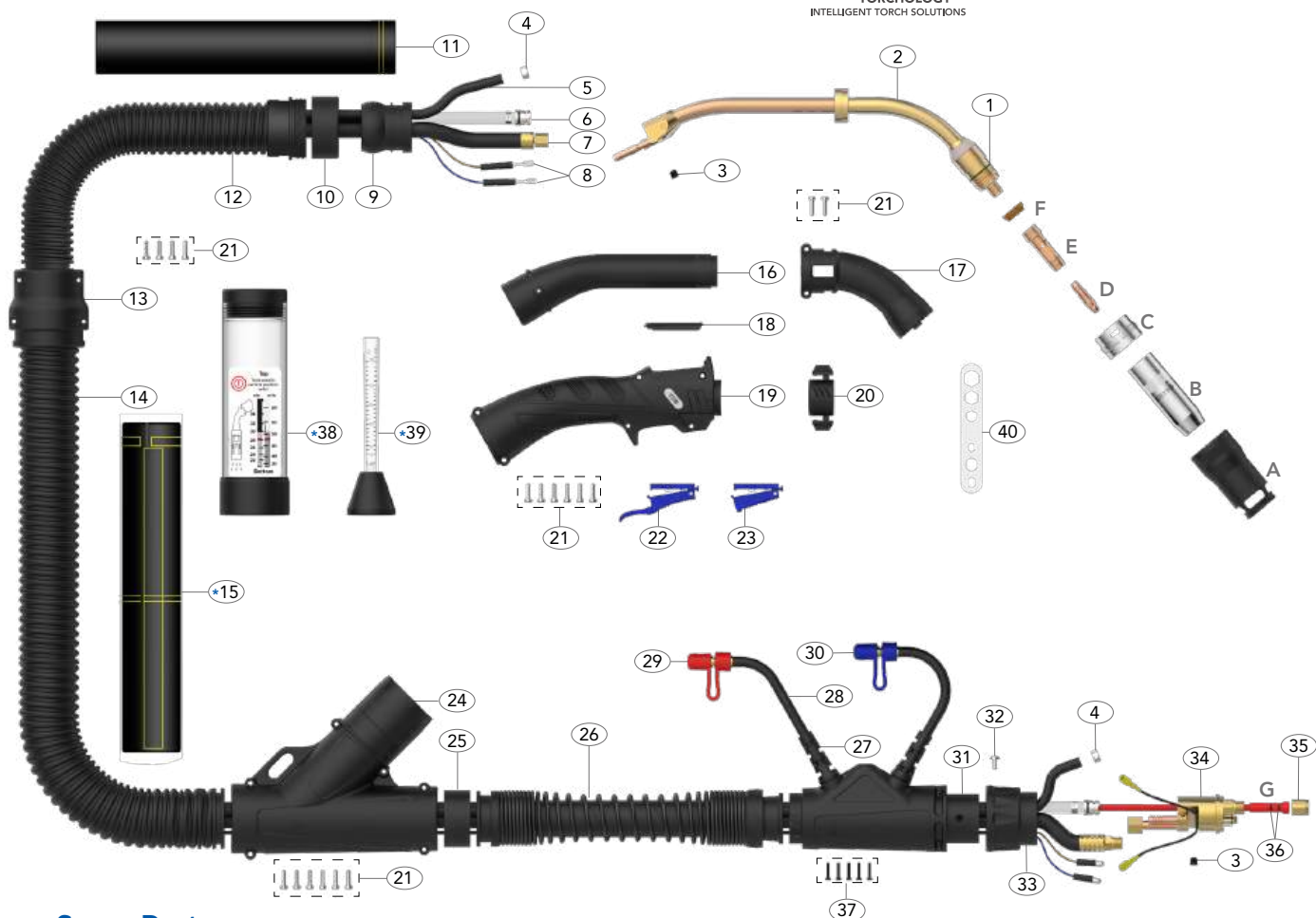

Spare Parts

Part Number	Description
1 AX3-NOR	Neck 'O' Ring
2 AX5002	Swan Neck Assembly
3 AM6X5	Outer Liner Retaining Screw
4 AM15400023	Water Hose Clamp 10mm
9 AX8015-1	Ball Joint
10 AX8015-2	Ball Joint Nut
11 AXLC-32 x 1.5M	Front Leather Cover 1.5mt
12 AX5019-1	Front Extract Hose Assembly
13 AX-HRC32-40	Hose Connector
16 AX3-IFC	Inner Fume Chamber
17 AX3-OFC	Outer Fume Chamber
18 AM2514-C	Handle Control Cover
19 AX3-AFR	Air Flow Regulator
20 AX2514	Fume Handle Assy
21 AXSP1-1	Screw Pack
22 AM2516L	Microswitch Extended TriggerA
23 M2516	Microswitch Standard Trigger
24 AX-YC	Y' Connector
25 AX5-SR	Sponge Seal Ring
26 AX5019-CS	Connect Spring Assembly
27 AM1820	Hose Support
28 AM5017	Water Outlet Hose Assembly
29 AM80320	Red Cap Stopper
30 AM80310	Blue Cap Stopper

Part Number	Description
31 AM5022	Housing Assembly
32 AM1526	Gun Plug Screw (M4 x 0.7)
33 AM1519	Gun Plug Nut
34 AM5098	Water-Cooled Plug Body Assembly
35 AM1826	Liner Retaining Nut
36 AMLOR	Liner 'O' Ring
37 AMSP1-1	Screw Pack
40 AMWS	Wear Parts Spanner

Cable Parts	Description	3m	4m	5m
5	Water Inlet Hose Assembly	AX5012-30	AX5012-40	AX5012-50
6	Outer Liner Assembly	AX5008-30	AX5008-40	AX5008-50
7	Power Cable Assembly	AX5015-30	AX5015-40	AX5015-50
8	Switch Lead Assembly	AX5010-30	AX5010-40	AX5010-50
14	Rear Extract hose Assembly	AX5019-30	AX5019-40	AX5019-50

Optional

*15	AXLC-40 x 0.75M	Rear Leather Cover 0.75mt
	AXLC-40 x 1.75M	Rear Leather Cover 1.75mt
	AXLC-40 x 2.75M	Rear Leather Cover 2.75mt
*38	AX3-AFM	Air Flow Meter
*39	AX-GFM	Gas Flow Meter

WEAR PARTS

Fume Series



Fume Nozzles

Part No.	Description	Wall	Material	X1	X2	X3	X5W
AX1FN	Fume Nozzle	1.0mm	Aluminium	●	●	●	●
AX2FN	Fume Nozzle	1.0mm	Aluminium	●	●	●	●
AX3FN	Fume Nozzle	1.0mm	Aluminium	●	●	●	●

Nozzles

Part No.	Description	Bore	Wall	Material	X1	X2	X3	X5W
AM1TN	Tapered Nozzle Assembly	10.6mm	1.0mm	Copper	●	●	●	●
AM1CN	Conical Nozzle Assembly	12.0mm	1.0mm	Copper	●	●	●	●
AM2TN	Tapered Nozzle Assembly	12.0mm	1.9mm	Copper	●	●	●	●
AM2CN	Conical Nozzle Assembly	15.0mm	1.9mm	Copper	●	●	●	●
AX3TN	Tapered Nozzle	12.0mm	2.5mm	Copper	●	●	●	●
AX3CN	Conical Nozzle	15.0mm	2.5mm	Copper	●	●	●	●
AX3CYN	Cylindrical Nozzle	18.0mm	2.5mm	Copper	●	●	●	●

● Standard wear part range ● Torch package standard wear part set-up

Fume Adaptors

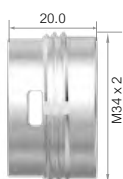
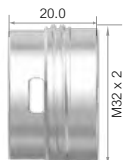
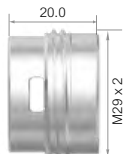

Part No.	Description	Material	X1	X2	X3	X5W
AX1002	Fume Nozzle Adaptor	Aluminium	●	●	●	●
AX2002	Fume Nozzle Adaptor	Aluminium	●	●	●	●
AX3002	Fume Nozzle Adaptor	Aluminium	●	●	●	●

Contact Tips

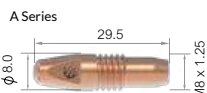
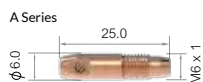

Part No.	Description	Size mm	Wire Size mm-Inch	Material	X1	X2	X3	X5W
Standard Series - Recommended for Fe, Fe-MC/FC Set-up								
AM1CT06	Contact Tip	M6*25.0	0.6-0.023	Copper	●	●	●	●
AM1CT08	Contact Tip	M6*25.0	0.8-0.030	Copper	●	●	●	●
AM1CT09	Contact Tip	M6*25.0	0.9-0.035	Copper	●	●	●	●
AM1CT10	Contact Tip	M6*25.0	1.0-0.040	Copper	●	●	●	●
AM1CT12	Contact Tip	M6*25.0	1.2-0.045	Copper	●	●	●	●
Standard Series - Recommended for Fe, Fe-MC/FC Set-up								
AM2CT08	Contact Tip	M8*29.5	0.8-0.030	Copper	●	●	●	●
AM2CT09	Contact Tip	M8*29.5	0.9-0.035	Copper	●	●	●	●
AM2CT10	Contact Tip	M8*29.5	1.0-0.040	Copper	●	●	●	●
AM2CT12	Contact Tip	M8*29.5	1.2-0.045	Copper	●	●	●	●
A Series - Recommended for Aluminium and SS Set-up								
AM1CT08A	Contact Tip	M6*25.0	0.8-0.030	Copper	●	●	●	●
AM1CT10A	Contact Tip	M6*25.0	1.0-0.040	Copper	●	●	●	●
AM1CT12A	Contact Tip	M6*25.0	1.2-0.045	Copper	●	●	●	●
A Series - Recommended for Aluminium and SS Set-up								
AM2CT08A	Contact Tip	M8*29.5	0.8-0.030	Copper	●	●	●	●
AM2CT10A	Contact Tip	M8*29.5	1.0-0.040	Copper	●	●	●	●
AM2CT12A	Contact Tip	M8*29.5	1.2-0.045	Copper	●	●	●	●

● Standard wear part range ● Torch package standard wear part set-up

Contact Tips

Standard Series

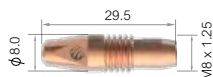

Part No.	Description	Size mm	Wire Size mm-inch	Material	Wire Type	X1	X2	X3	X5W
Standard Series - Recommended for Fe, Fe-MC/FC Set-up									
AM5CT09	Contact Tip	M8*29.5	0.9-0.035	CuCrZr	Fe, Fe-FC/MC SS,SS-FC/MC upto 1.2mm	●	●	●	●
AM5CT10	Contact Tip	M8*29.5	1.0-0.040	CuCrZr		●	●	●	●
AM5CT12	Contact Tip	M8*29.5	1.2-0.045	CuCrZr		●	●	●	●
AM5CT14	Contact Tip	M8*29.5	1.4-0.055	CuCrZr		●	●	●	●
AM5CT16	Contact Tip	M8*29.5	1.6-0.063	CuCrZr		●	●	●	●

Standard Series



Standard Series - Recommended for Fe, Fe-MC/FC Set-up									
AM6WCT09	Contact Tip	M10*35.5	0.9-0.035	CuCrZr	Fe, Fe-FC/MC SS,SS-FC/MC upto 1.2mm	●	●	●	●
AM6WCT10	Contact Tip	M10*35.5	1.0-0.040	CuCrZr		●	●	●	●
AM6WCT12	Contact Tip	M10*35.5	1.2-0.045	CuCrZr		●	●	●	●
AM6WCT14	Contact Tip	M10*35.5	1.4-0.055	CuCrZr		●	●	●	●
AM6WCT16	Contact Tip	M10*35.5	1.6-0.063	CuCrZr		●	●	●	●

A Series



A Series - Recommended for Aluminium and SS Set-up									
AM5CT10A	Contact Tip	M8*29.5	1.0-0.040	CuCrZr	Aluminium SS,SS-FC/MC upto 1.6mm	●	●	●	●
AM5CT12A	Contact Tip	M8*29.5	1.2-0.045	CuCrZr		●	●	●	●
AM5CT16A	Contact Tip	M8*29.5	1.6-0.063	CuCrZr		●	●	●	●
AM2CT10A	Contact Tip	M8*29.5	1.0-0.040	Copper		●	●	●	●
AM2CT12A	Contact Tip	M8*29.5	1.2-0.045	Copper		●	●	●	●





A Series



A Series - Recommended for Aluminium and SS Set-up									
AM6WCT10A	Contact Tip	M10*35.5	1.0-0.040	CuCrZr	Aluminium SS,SS-FC/MC 1.6mm	●	●	●	●
AM6WCT12A	Contact Tip	M10*35.5	1.2-0.045	CuCrZr		●	●	●	●
AM6WCT16A	Contact Tip	M10*35.5	1.6-0.063	CuCrZr		●	●	●	●
AMC6WCT10A	Contact Tip	M10*35.5	1.0-0.040	Copper		●	●	●	●
AMC6WCT12A	Contact Tip	M10*35.5	1.2-0.045	Copper		●	●	●	●

● Standard wear part range ● Torch package standard wear part set-up

Tip Adaptors

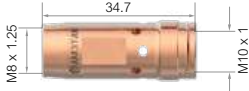
	Part No.	Description	Material	X1	X2	X3	X5W
	AM1TA	Tip Adaptor	Brass	●	●	●	●
	AM2TA	Tip Adaptor	Brass	●	●	●	●
	AM3TAB AM3TAC	Tip Adaptor Tip Adaptor High Performance	Brass CuCrZr	●	●	●	●
	AM3TAB-M10 AM3TAC-M10	Tip Adaptor M10 Tip Adaptor High Performance M10	Brass CuCrZr	●	●	●	●
	AX5WTAC	Tip Adaptor	CuCrZr	●	●	●	●
	AX5WTAC-M10	Tip Adaptor M10	CuCrZr	●	●	●	●

● Standard wear part range ● Torch package standard wear part set-up

Insulators

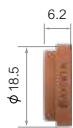

Part No.	Description	X1	X2	X3	X5W
AX5WTAI	Tip Adaptor Insulator				



AX1003	Neck Insulator				
--------	----------------	--	--	--	--



AX2003	Neck Insulator				
--------	----------------	--	--	--	--

● Standard wear part range ● Torch package standard wear part set-up

Liners

Filler Metal

Steel Liner Recommended for: Fe, Fe-MC/FC. Light and medium duty applications

Part No.	Description	Nipple	Wire Size mm	X1	X2	X3	X5W
AM1535-30	Steel Liner x 3mt	Moulded Nipple	0.6-0.9	●	●	●	●
AM1535-40	Steel Liner x 4mt	Moulded Nipple	0.6-0.9	●	●	●	●
AM1535-50	Steel Liner x 5mt	Moulded Nipple	0.6-0.9	●	●	●	●



AM2524-30	Steel Liner x 3mt	Moulded Nipple	1.0-1.2	●	●	●	●
AM2524-40	Steel Liner x 4mt	Moulded Nipple	1.0-1.2	●	●	●	●
AM2524-50	Steel Liner x 5mt	Moulded Nipple	1.0-1.2	●	●	●	●



AM3631-30	Steel Liner x 3mt	Moulded Nipple	1.6	●	●	●	●
AM3631-40	Steel Liner x 4mt	Moulded Nipple	1.6	●	●	●	●
AM3631-50	Steel Liner x 5mt	Moulded Nipple	1.6	●	●	●	●



Al - Combi Liner Recommended for: Al, can be used for SS, SS-MC/FC

Part No.	Description	Contact Tip	Wire Size mm	X1	X2	X3	X5W
AM1564-30	Combi-Liner x 3mt	A Series	0.8-1.2	●	●	●	●
AM1564-40	Combi-Liner x 4mt	A Series	0.8-1.2	●	●	●	●
AM1564-50	Combi-Liner x 5mt	A Series	0.8-1.2	●	●	●	●
AM2564-30	Combi-Liner x 3mt	A Series	1.2-1.6	●	●	●	●
AM2564-40	Combi-Liner x 4mt	A Series	1.2-1.6	●	●	●	●
AM2564-50	Combi-Liner x 5mt	A Series	1.2-1.6	●	●	●	●



● Standard wear part range ● Torch package standard wear part set-up

ARC X SERIES

Make Work Life Easier

2025.06



MAKE WORK
LIFE EASIER